

PT5600

Industrial Grade • String Encoder

Absolute Linear Position to 250 inches (6350 mm)

Hard Anodized Aluminum Enclosure

Mates To Virtually Any Encoder

Available With or Without Encoder



GENERAL

Full Stroke Range Options	0-50 to 0-250 inches
Motion Conversion Ratio	8 inches per turn, <i>see ordering information</i>
Accuracy	the lesser of 0.02% full stroke or 0.04% of measurement range
Measuring Cable Options	stainless steel or thermoplastic
Module Material	hard anodized aluminum
Maximum Allowable Rotational Sensor Torque	1.0 in-lbs.
Weight	5 lbs. max.

ENVIRONMENTAL

Operating Temperature	-40° to 200°F (-40° to 90°C)
-----------------------	------------------------------

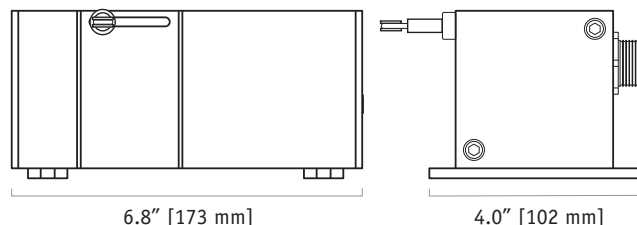
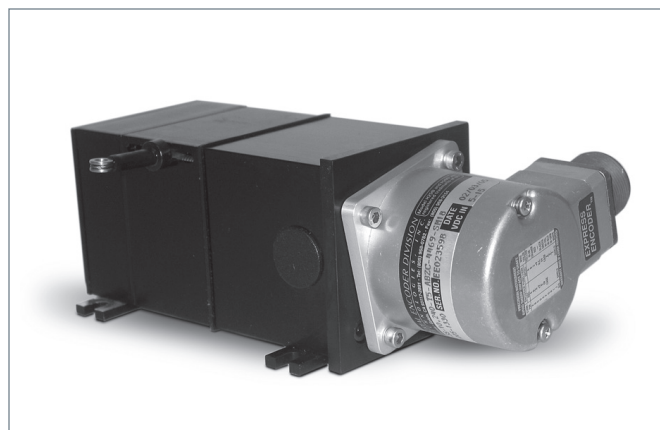

Our unique linear-to-rotational, industrial-grade string encoder module mates to virtually any encoder, giving you a cost-effective linear position measurement solution that precisely fits your requirements. The PT5600 takes just minutes to install, fits easily into tight areas, does not require perfectly parallel alignment, and provides reliable and precise position measurements without needing periodic adjustments.

For any high resolution or absolute encoder requirement, the PT5600 delivers the ultimate in flexibility. To order, simply select the measurement range and encoder mounting style—it's that easy! We even supply all the necessary encoder mounting tools and attaching hardware. If you can't find your encoder mounting style or you want us to provide the encoder, please give us a call.

Ordering Information:

Model Number:

PT5600 - _____ - _____ - _____ - _____
order code: **R** **A** **B** **C**

Sample Model Number:

PT5600 - 100 - N34 - FR - F01

- R** range: 100 inches
- A** measuring cable: .034 nylon-coated stainless
- B** cable exit: front
- C** rotational sensor mounting style: F01 (2.5-in. sq. flange)

» *Trying to reorder but can't find your existing model number? Please contact factory for help.*

Full Stroke Range:

R <i>order code:</i>	50	100	150	200	250
full stroke range, min:	50 in.	100 in.	150 in.	200 in.	250 in.
cable tension (±20%):	41 ounces	41 ounces	41 ounces	21 ounces	21 ounces

Ordering Information (cont.):

Measuring Cable:

order code:	N34	S47	V62
cable construction:	Ø.034-inch nylon-coated stainless steel rope	Ø.047-inch bare stainless steel rope	Ø.058-inch PVC jacketed vectra fiber rope
available ranges:	all ranges	all ranges up to 150 inches	all ranges up to 150 inches
conversion ratio:	1 turn = 8.002 ± 0.022 inches	1 turn = 8.042 ± 0.022 inches	1 turn = 8.077 ± 0.022 inches

Cable Exit:

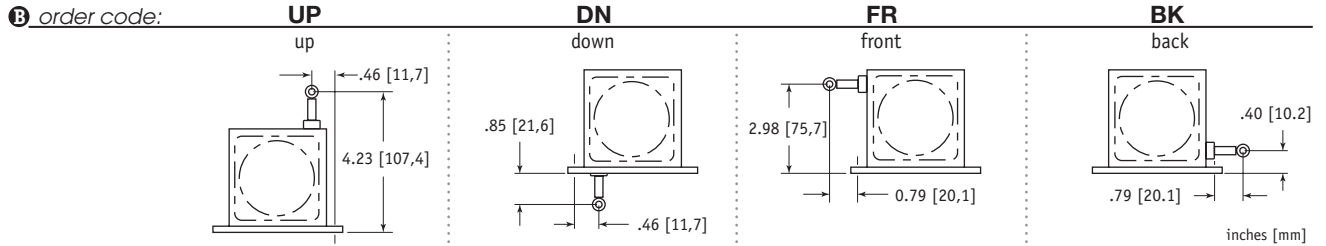

Rotational Sensor Mounting Style:

order code:	F01	F02	S01	S02	S04
	2.5-in. Flange Mount 3/8-inch shaft	2-in. Flange Mount 3/8-inch shaft	Face-Mount 6 mm shaft M4 mounting screws	Face-Mount 10 mm shaft M4 mounting screws	Face-Mount 10 mm shaft M3 mounting screws

Note: If you don't see your encoder style, please contact factory. All encoder types supported.

F01 - 2½-inch Sq. Flange Mount (3/8-inch shaft)

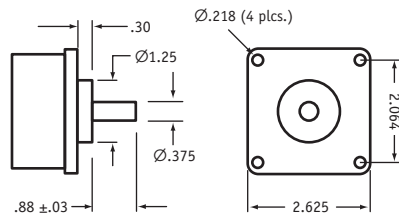

F02 - 2-inch Sq. Flange Mount (3/8-inch shaft)

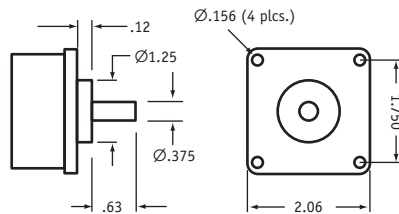

S01 - Face-Mount (6mm shaft/M4 screws)

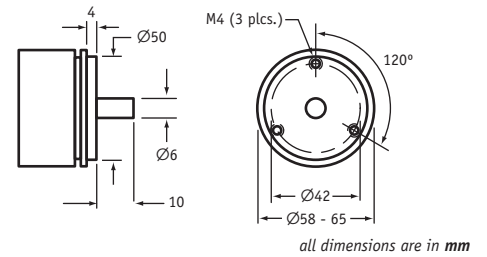

S02 - Face-Mount (10mm shaft/M4 screws)

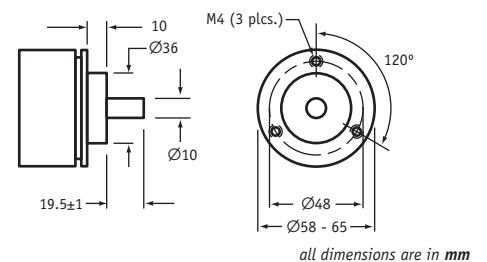

S04 - Face-Mount (10mm shaft/M3 screws)

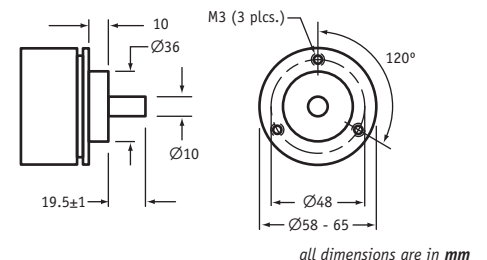

Outline Drawing:

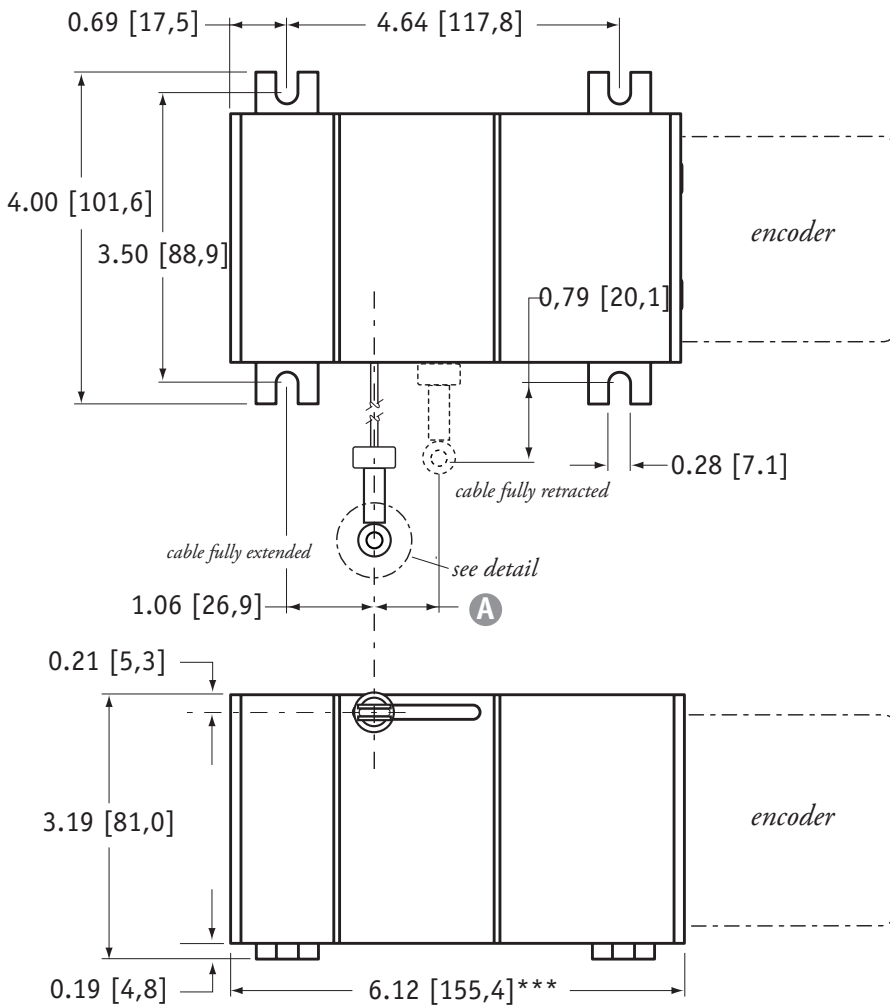

A DIMENSION - INCHES [MM]

stroke range	measuring cable	
	S47 • V62	N34
50	0.39 [9,9]	0.23 [5,9]
100	0.78 [19,7]	0.46 [11,7]
150	1.16 [29,6]	0.69 [17,6]
200	n/a	0.92 [23,5]
250	n/a	1.16 [29,3]

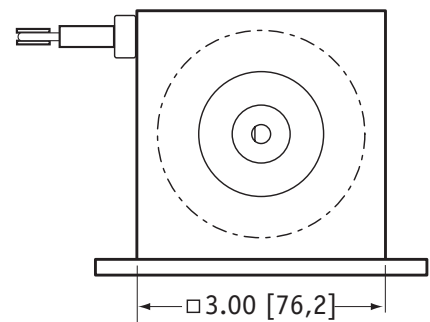
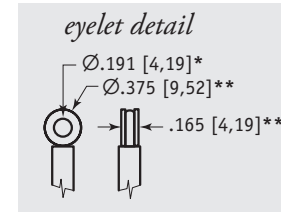

DIMENSIONS ARE IN INCHES [MM]

tolerances are ± 0.02 in. [$\pm 0,5$ mm] unless otherwise noted

note: *tolerance = $+0.005 -0.001$ [+13 -03] **tolerance = $+0.005 -0.005$ [+13 -13] ***Overall dimension may vary depending on encoder configuration

联系方式



深圳市亿为测控电子有限公司
Shenzhen Bill-Well Measurement & Control Electronics Co., Ltd.

广东省深圳市南山区创业路怡海广场东座2407 邮编：518000

电话：+86 755 2641 9890 传真：+86 755 2641 9680

电子邮箱：sales@bill-well.com