

Z115

OEM Series • Voltage Divider Output

Ranges: 0–100 to 0–1000 mm

Compact, Open Frame Design

OEM Applications • Customer Specific Design

100-piece Minimum Order

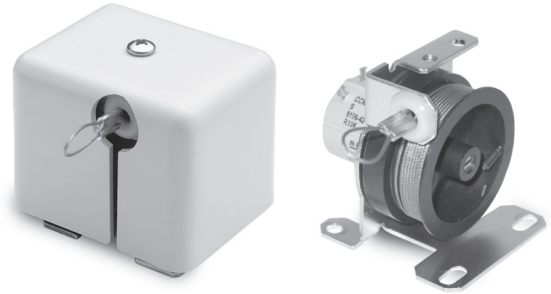

GENERAL

Full Stroke Ranges	0-100 to 0-1000 mm
Spool Circumference	58 mm, 115 mm (range dependant)
Output Signal	voltage divider (potentiometer)
Accuracy	+0.25 to +0.15% of F.S.*
Repeatability	+0.15% to +0.075% of F.S.*
Resolution	essentially infinite
Measuring Cable	0.034-in dia. nylon-coated stainless steel
Sensor	plastic-hybrid precision potentiometer
Frame Material	zinc-plated steel
Cover Material	plastic
Weight, max.	1 lb.

ELECTRICAL

Input Resistance	500 or 10K ohms (+10%)
Power Rating, Watts	2.0 at 25°C derating to 0 at 105°C

ENVIRONMENTAL

Operating Temperature	-25°C to +105°C
Temperature Coefficient of Potentiometer	+100ppm/°C, -150ppm/°C

**specifications may vary with configuration, please consult factory*

The Z115 Cable-Extension Transducer is a compact, flexible and highly accurate linear position measurement device that can be engineered to OEM specifications.

The standard Z115, can be simply modified to meet specific requirements. Circuits can be added for regulated output. Designs are available with and without covers and can be engineered for drop-in replacement of current assemblies. They allow for custom mounting, custom electrical connections and customer-specified life testing. Quantities are available as small as 100 units.

Output Signal

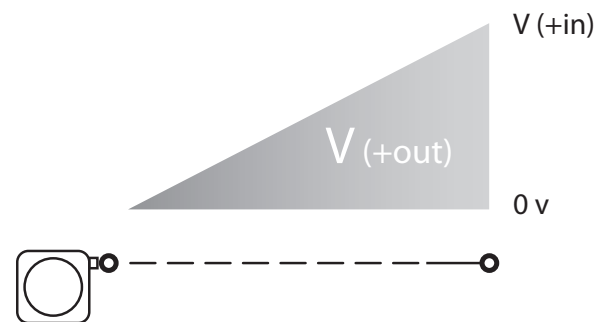

Outline Drawing:

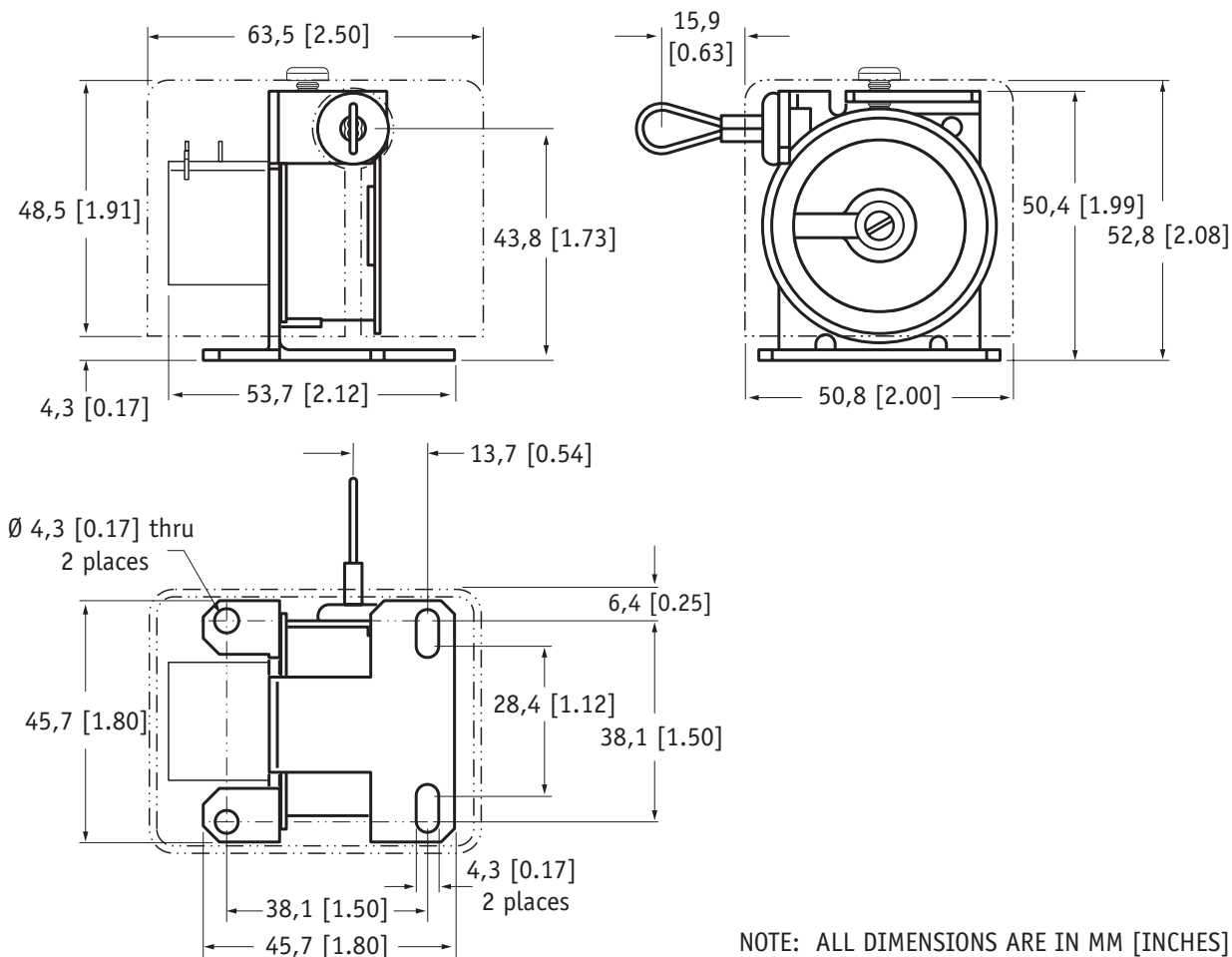

Ordering Information:

Application:

<please provide a brief description of application. include exact stroke range, velocity of stroke and estimated number of cycles per year.>

Full Stroke Range:

<select available range or specify complete requirements>

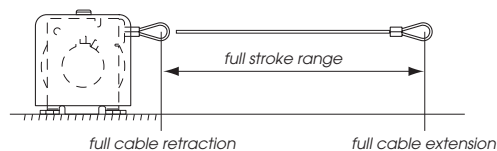

<i>full stroke range (mm):</i>	50	100	275	550	1100
<i>spool circumference (mm):</i>	58	115	58	58	115
<i>potentiometer turns:</i>	1	1	5	10	10
<i>spring tension, ±30% (oz):</i>	10	7	10	10	7

Ordering Information (cont.):

Measuring Cable Exit

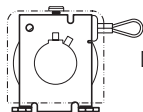

front

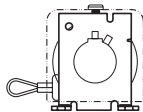

rear

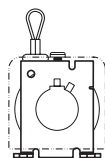

up

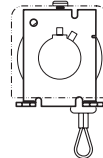

down

Potentiometer

<select value or specify complete requirements including value, voltage and linearity and estimated number of cycles per year>

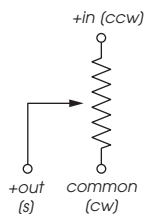

500 Ω

10K Ω

other:

Enclosure

<select no cover or specify custom enclosure requirements>

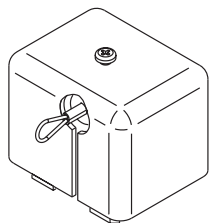

cover

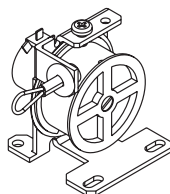

no cover

custom enclosure:

Electrical Connection

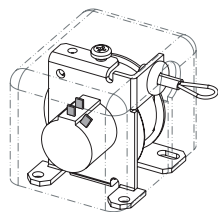

solder connection

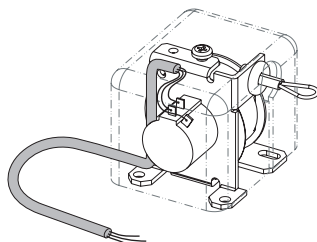

instrumentation cable

length:

connector

manufacturer:

manufacturer's part no.:

联系方式



深圳市亿为测控电子有限公司
Shenzhen Bill-Well Measurement & Control Electronics Co., Ltd.

广东省深圳市南山区创业路怡海广场东座2407 邮编：518000

电话：+86 755 2641 9890 传真：+86 755 2641 9680

电子邮箱：sales@bill-well.com