



- Keyed Shaft couplings
- Range from  $\pm 0.05$  to  $\pm 2$  Nm ( $\pm 0.04$  to  $\pm 1.6$  lbf.ft)
- Integrated Mechanical Stops
- Aluminum
- Cable Gland or Connector Output
- Built In Amplifier per Request

## DESCRIPTION

The **CD1110** series of dynamic torque sensors have extremely low operating ranges protected by mechanical stops permitting an overload of 10 times the F.S. measurement range. The rugged design provides accurate bidirectional torque measurements of rotating components up to 2000 rpm. Optionally the **CD1110** can receive an on-board amplifier for high-level voltage output. Signal amplification is accomplished before transmission via the slip ring assembly, thus eliminating the noise generated by the contacts. It is also possible to eliminate the contact residual drag torque by placing the transducer sensing element directly in contact with the torque to be measured.

With many years of experience as a designer and manufacturer of sensors, Measurement Specialties, Inc. often works with customers to design or customize sensors for specific uses and testing environments.

To meet your needs we also offer complete turnkey systems. The matched components (sensor, power, amplifier and digital display) are formatted, calibrated and ready for immediate use.

## FEATURES

- Ranges from  $\pm 0.05$  to  $\pm 2$  Nm ( $\pm 0.04$  to  $\pm 1.6$  lbf.ft)
- Integrated Mechanical Stops
- Keyed shaft mechanical connection
- High Level Output Model with Integrated Amplifier

## APPLICATIONS

- Low range dynamic applications
- Process control equipment
- Test and Measurement
- Robotics and effectors
- Laboratory and Research

## STANDARD RANGES

<b>F.S range in Nm</b>	0.05	0.3	0.5	1	2
<b>F.S range in lbf.ft</b>	0.04	0.22	0.4	0.8	1.6
<b>Rotation in rpm</b>	2000	2000	2000	2000	2000

# CD1110 Dynamic Rotary Torque Sensor

## PERFORMANCE SPECIFICATIONS

All values are typical at temperature 20±1° C

Parameters	
Operating Temperature Range (OTR)	-20 to 80° C (-4 to 176° F)
Compensated Temperature Range (CTR)	0 to 60° C (32 to 140° F)
Zero Shift in CTR	<0.5% F.S./ 50° C [/100° F]
Sensitivity Shift in CTR	<1% of reading / 50° C [/100° F]
Range (F.S.)	±0.05 to ±2Nm [4 to 1.6 lbf.ft]
Velocity of Rotation	≤2000 rpm ; Bidirectional operation
Over-Range	
Without Damage	10 x F.S. or 10Nm [max. 8lb-ft]
Accuracy	
Combined Non-Linearity & Hysteresis	±0.25%F.S.

### Electrical Characteristics

Model	CD1110	CD1110-A1	CD1110-A2
Supply Voltage	10Vdc	10 – 30Vdc	±15Vdc (±12 to ±18Vdc)
F.S. Output <sup>4</sup>	±2mV/V	±2V ±5%	±5V ±5%
Zero Offset <sup>4</sup>	<±5% F.S.	2.5V ±5% F.S.	0V ±5% F.S.
Input Impedance/Consumption	700Ω	<30mA	<30mA
Output Impedance	700Ω	1 kΩ <sup>5</sup>	1 kΩ <sup>5</sup>
Insulation under 50Vdc	≥100MΩ	≥100MΩ	≥100MΩ

### Notes

1. Electrical Termination: Connector output including mate
2. Material: Body and housing in aluminum alloy
3. Connection : Keyed shaft standard, other connection types on request (smooth shaft, cotter pin, etc)
4. Other signal output on request
5. Output impedance < 100Ω on request
6. CE conformance according to EN 61010-1, EN 50081-1, EN 50082-1

# CD1110 Dynamic Rotary Torque Sensor

## DIMENSIONS & WIRING SCHEMATIC (IN METRIC AND IMPERIAL)

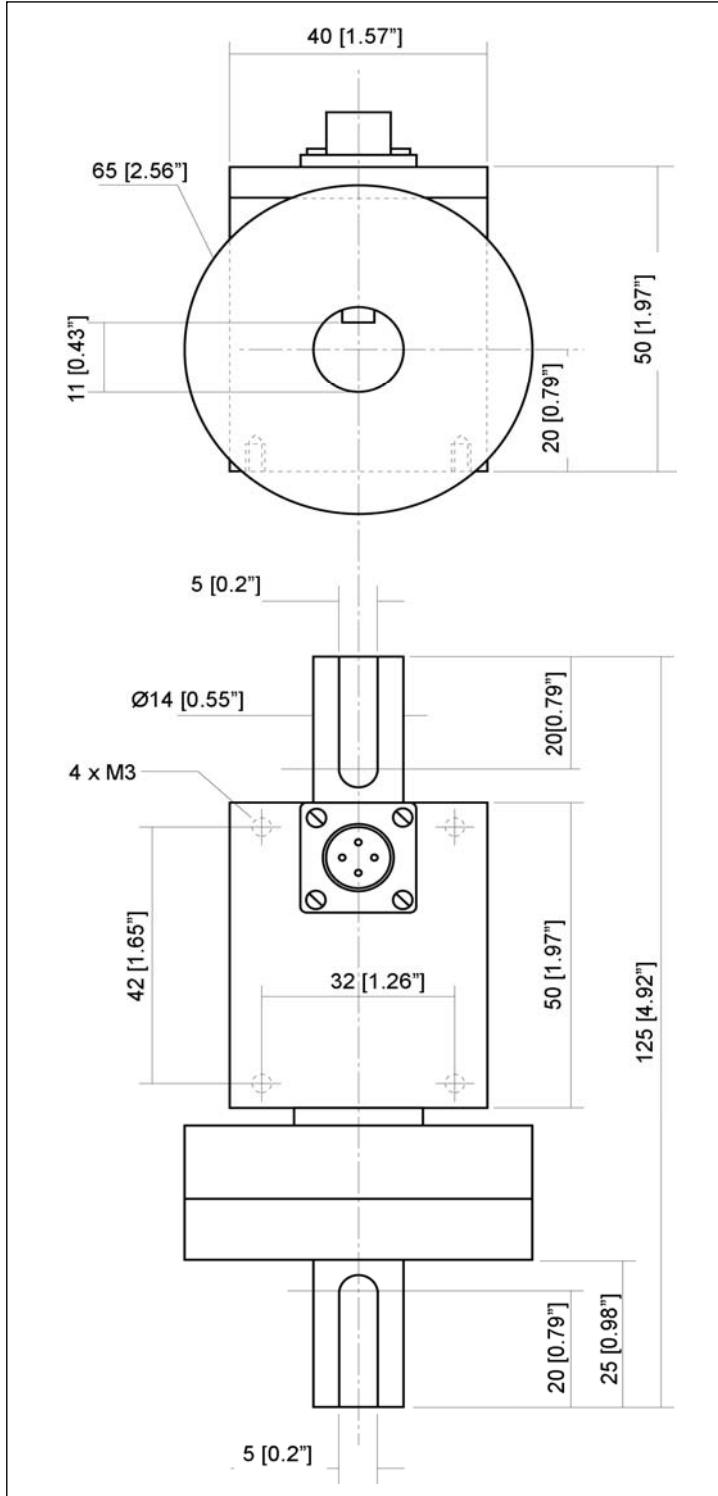

### Wiring Schematic

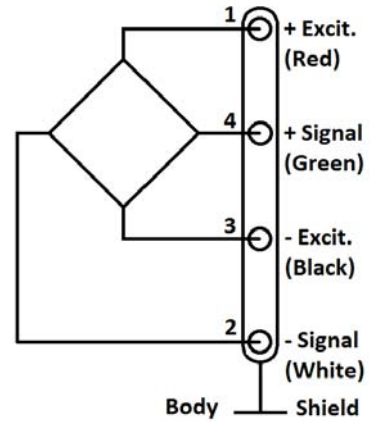

### Version -A1

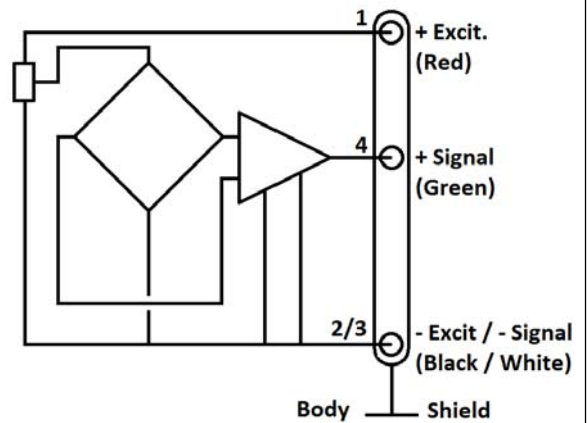

### Version -A2

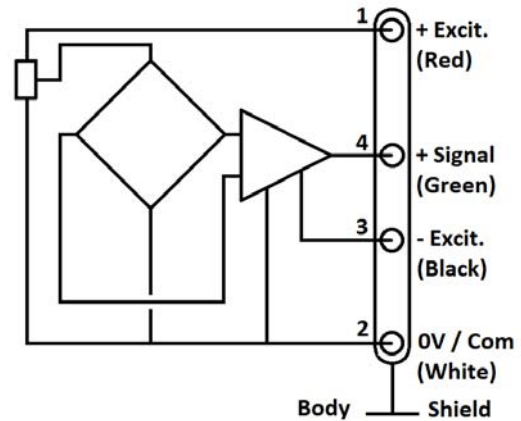

# CD1110 Dynamic Rotary Torque Sensor

## OPTIONS

<b>A1</b> : Amplified Tension output with unipolar power supply
<b>A2</b> : Amplified Tension output with bipolar power supply
<b>FMC</b> : Mating connector fitting with 2 m [6.6 ft] cable
<b>PE</b> : Cable Gland Termination with 2 m [6.6 ft] cable

## ORDERING INFO

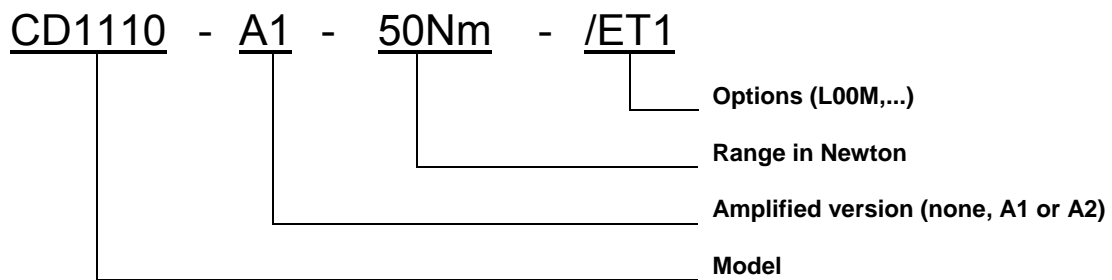

## 联系方式



深圳市亿为测控电子有限公司  
Shenzhen Bill-Well Measurement & Control Electronics Co., Ltd.

广东省深圳市南山区创业路怡海广场东座2407 邮编：518000  
电话：+86 755 2641 9890 传真：+86 755 2641 9680  
电子邮箱：sales@bill-well.com